

OSAKA CASTLE MUSEUM

OSAKA CASTLE MUSEUM

大 阪 城 天 守 閣

Information

Address 1-1 Osakajo, Chuoku, Osaka City 540-0002
Telephone 06-6941-3044
Facsimile 06-6941-2197
Open 9:00 a.m. to 5:00 p.m. (Last admission is at 4:30 p.m.)
Opening hours may be extended in some cases.
Closed December 28th through January 1st
Admission Adults ¥600 / Free for children aged 15 and under (ID required)
(A "Group Discount" is available for groups of 15 or more.)

*Exhibits on the 3rd and 4th floors are replaced for their protection and preservation every 2 months.
*Restrooms are located on the 2nd floor only.

Osaka Castle Museum Website

An overview of the museum, the latest information on exhibitions and related events, and access information can be found on the official website.

<https://www.osakacastle.net/>

Issued on May 1, 2023

Design:SHIRUSHI(SHIRUSHI DESIGN FACTORY)

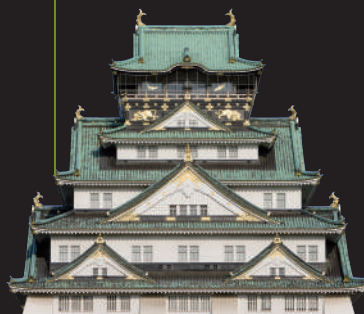

OSAKA CASTLE MUSEUM STAMP



Folding screen, "Namban Byobu", depicting Namban ships (sailing ships from Europe) at anchor ports in Japan and China

Wooden statue of Hideyoshi Toyotomi

Folding screen bearing poems autographed by Hideyori Toyotomi

Fan, bearing the design of autumn flowers

Folding screen illustrating the Summer War in Osaka

Cuirass (domaru type), braided with light indigo and scarlet cords

Folding screen illustrating the Battle of Shizugatake

The Turbulent History of Osaka Castle

Ishiyama Honganji Era

In 1496 a high-ranking monk of the Joudoshinshu sect had a monastic residence built near the site of present-day Osaka Castle. This eventually grew into a large temple known as Ishiyama (Osaka) Honganji. The temple boasted great power and influence until 1580 when it yielded to Nobunaga Oda during his campaign of national unification and was burned to the ground.

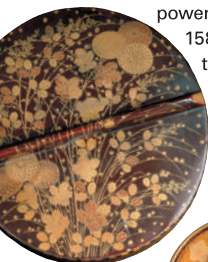

Inkstone case, bearing the design of autumn flowers in *maki-e* style

Osaka Castle under Toyotomi

After the death of Nobunaga Oda, Hideyoshi Hashiba (Toyotomi) took control of political affairs and began construction of a castle on the site of Ishiyama Honganji in 1583. He built a castle befitting the permanent residence of the ruler of Japan. However, after his death, political control moved to the Tokugawas and the castle fell during the Summer War in Osaka 1615.



European-style helmet, inlaid with gold and silver patterns



Surcoat bearing the design of Mt. Fuji on a yellow and black wool background

Reconstruction by the Tokugawa Shogunate

By command of the second shogun, Hidetada, reconstruction of Osaka Castle began in 1620. It was a large-scale reconstruction that took 10 years to complete. In 1665 the Main Tower was destroyed by a lightning strike. However the castle played a major role as the base for the Shogunate's control of Western Japan. Many buildings were later destroyed by fires during the turbulent transition to imperial restoration.

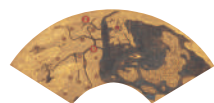

Hanging scroll with fan-shaped pictures illustrating three countries: Japan, Ming (China) and Korea

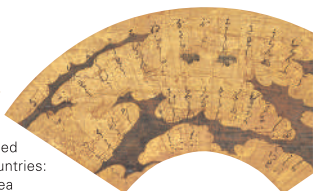

Reconstruction of the Main Tower in the Showa Period

After the Meiji period, the site of Osaka Castle was used by the army. During this time, in 1931, public efforts and enthusiasm brought about the reconstruction of the Main Tower, and it was included in the list of Registered Cultural Properties of Japan in 1997. The area around the Castle was damaged during the bombing raids of World War II, but restored and turned into a historic site park after the war.

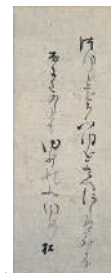

Autographed farewell poem, composed and written by Hideyoshi Toyotomi

*Exhibits are replaced from time to time.



Map of Osaka Castle Park

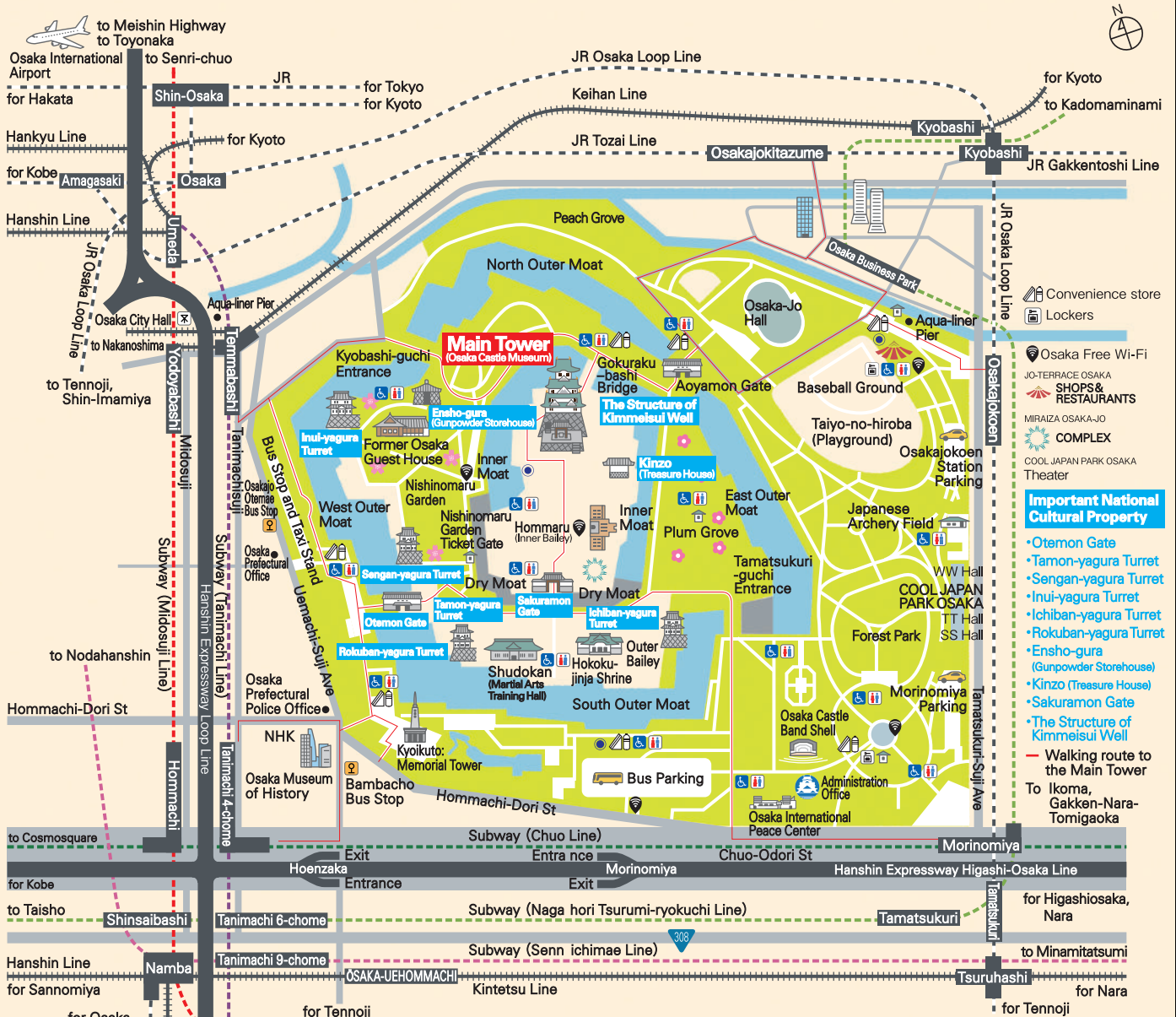

Important National Cultural Property

- Otomon Gate
- Tamon-yagura Turret
- Sengan-yagura Turret
- Inui-yagura Turret
- Ichiban-yagura Turret
- Rokuban-yagura Turret
- Ensho-gura (Gunpowder Storehouse)
- Kinzo (Treasure House)
- Sakuramon Gate
- The Structure of Kimmetsui Well

— Walking route to the Main Tower
 To Ikoma, Gakken-Nara-Tomigaoka

How to Get Here

- Numbers in brackets indicate subway exits. *It takes 15 to 20 minutes to walk from each station.
- Subway Tanimachi Line: Tanimachi 4-chome (1-B) or Temmabashi (3)
 - Subway Chuo Line: Tanimachi 4-chome (9) or Morinomiya (1, 3-B)
 - Subway Nagahori Tsurumi-ryokuchi Line: Osaka Business Park (1) or Morinomiya (3-B)
 - JR Osaka Loop Line: Morinomiya or Osakajokoen ■ JR Tozai Line: Osakajokitazume
 - Keihan Line: Temmabashi or Kyobashi ■ Kintetsu Line: Tsuruhashi transfer to JR Morinomiya or JR Osakajokoen
 - Buses: Osakajo Otemae or Bambacho ■ Aqualiner: Osakajo Pier or Hachiken-yahama Pier

- Smoking area
 3 smoking areas are located in the park.
 Thank you for not smoking except this smoking area.
- 🚫 Drone PROHIBITED in Osaka Castle Park.

The Main Tower of Osaka Castle stands tall against the sky at the center of the extensive premises of the castle. The observation deck on the 8th floor commands a panoramic view of Osaka Castle Park and the Osaka Plain, while the exhibition rooms showcase authentic historical artifacts. You can learn first-hand about the attractive features of castles, dramatic stories of warlords and the interesting history of Osaka.



1F

Museum Entrance



■ Information Counter



■ Museum Shop

■ Audio Guide Rental Counter
(Japanese, English, Korean, and Chinese)

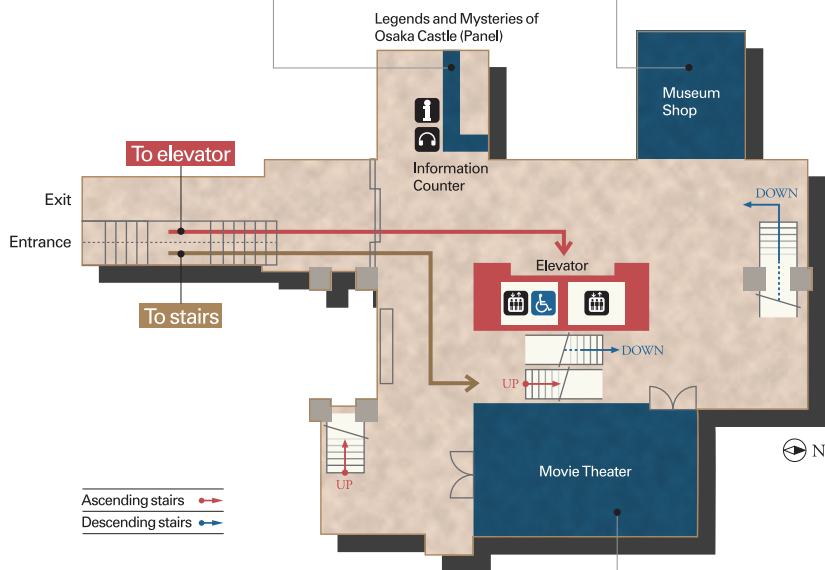

Elevators

- * Usually, the elevators go directly to the 5th floor without stopping on other floors and are used for ascending only.
- * For wheelchair users and other physically disabled persons, an elevator that goes directly to the 8th floor is available. If you need to use this elevator, please contact a staff member.



■ Movie Theater

A series of five programs concerning Hideyoshi Toyotomi and Osaka Castle are shown with subtitles in Japanese, English, Korean, and Chinese. Running time is approximately 5 minutes each.



Information Counter



Audio Guide Rental Counter



Elevator



Elevator for Disabled Persons

2_F

Osaka Castle Facts & Figures

- **Display Panels**
Panels are displayed showing basic facts about Osaka Castle and other castles.
- **Osaka Castle History at a Glance: "After the Tokugawa Regime and the Meiji Period"** (Running time: 3 minutes)

■ Replicas

Full-scale replicas of the SHACHI (legendary dolphin-shaped fish) and FUKUKO (crouching tigers) currently in use in the Main Tower are on display.



* Restrooms are located on the 2nd floor only.

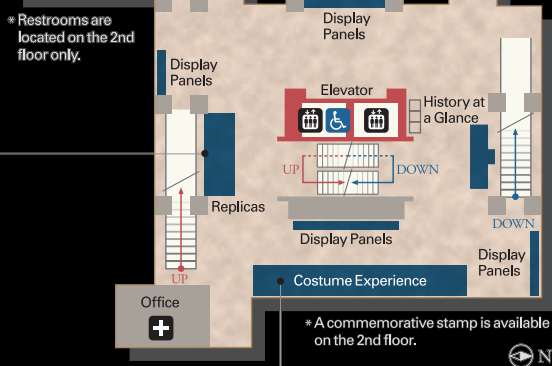

* A commemorative stamp is available on the 2nd floor.

- **Experience wearing a samurai helmet and battle surcoat** (¥500 per person)
You can try on a restored helmet and battle surcoat of a warlord in the Sengoku era (the age of provincial wars), and use your camera to have your photograph taken.



3_F

Hideyoshi Toyotomi and His Era

- **Historical Artifact Selections**
(Exhibits are changed from time to time.)
- **Full-Scale Replica: The Golden Tea Room**
(a portable tea room constructed by Hideyoshi Toyotomi)
- **Osaka Castle History at a Glance: "Osaka Castle in the Edo Period"**
(Running time: 3 minutes)
- **Exhibition Catalog Shop**



No Photography

Armor with two-part iron cuirass
(Owned by Yukimura Sanada)

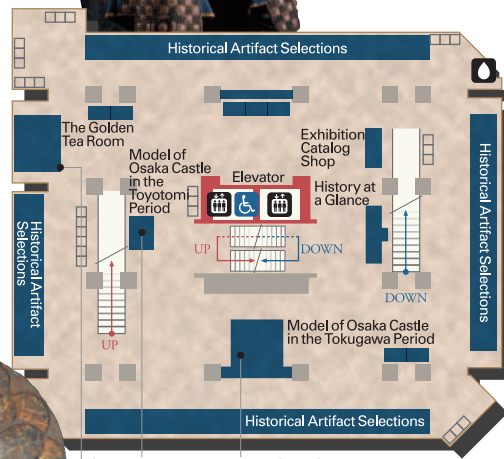

Cultural property designated by Osaka City
Large ornamental gilded roof tile with a chrysanthemum design
(A gilded roof tile of Osaka Castle dating back to the Toyotomi reign)



■ The Golden Tea Room



■ Model of Osaka Castle



Model of Osaka Castle in the Toyotomi Period

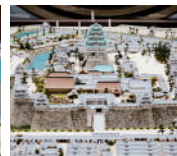

Model of Osaka Castle in the Tokugawa Period

4F

Hideyoshi Toyotomi and His Era

Objects associated with Hideyoshi Toyotomi and other artifacts and records of the Sengoku era (the age of provincial wars) and Osaka Castle are on display.



No Photography

Historical Artifact Selections

(Exhibits are changed from time to time.)

Osaka Castle History at a Glance:

“Osaka Castle Reconstructed by the Tokugawa Shogunate” (Running time: 3 minutes)

Lacquered Western-style box with a mother-of-pearl inlaid flower-and-tree design (Lacquerware for export to Europe)

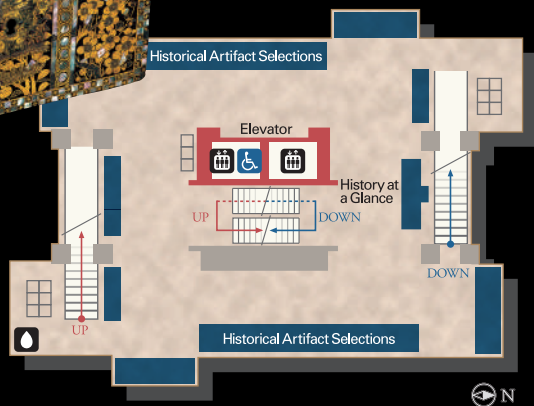

Folding screen illustrating the town of Osaka and the banks of the Yodo River (Osaka Castle depicted here is the one rebuilt by the Tokugawa shogunate.)

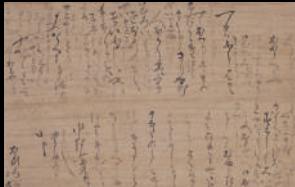

Letter written by Hideyoshi Toyotomi to Ohiori, dated September 26
This letter was written by Hideyoshi Toyotomi himself to his young son, later named Hideyori.



Portrait of Hideyoshi Toyotomi, reportedly painted by Mitsunobu Kano

5F

Scenes from “The Summer War in Osaka” Folding Screen

War scenes are visualized with images and miniature figures.

■ Osaka Castle History at a Glance: “Osaka Castle under Hideyoshi Toyotomi” (Running time: 3 minutes)

■ Panorama Vision: “The Summer War in Osaka”

Watch a movie of the famous scenes of the folding screen of the Summer War in Osaka.

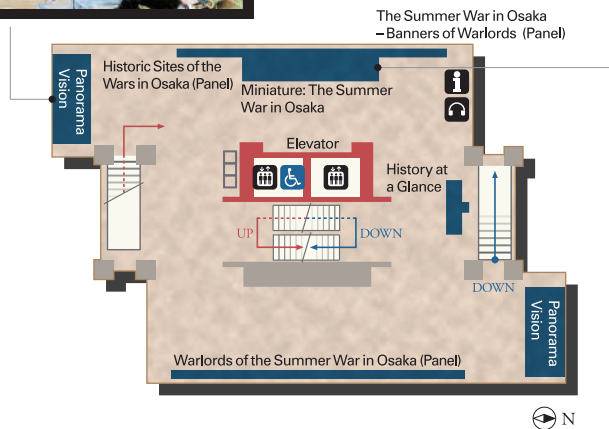
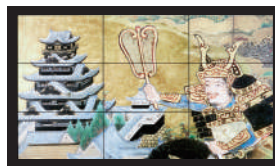

■ Miniature: “The Summer War in Osaka”

The intense battle between the troops of Yukimura Sanada and Tadanao Matsudaira is shown by means of miniature figures.



* The 6th floor is closed to visitors.



Elevator



No Photography



Drinking Fountain

*Exhibits are changed from time to time.



Information Counter



Audio Guide Rental Counter



Elevator

7 F

The Life of Hideyoshi Toyotomi

Presentation of the life of Hideyoshi, who built Osaka Castle and succeeded in unifying the entire nation

- **Osaka Castle History at a Glance: "The Period of Ishiyama Honganji"**
(Running time: 3 minutes)

- **Historical Facts and Theories**

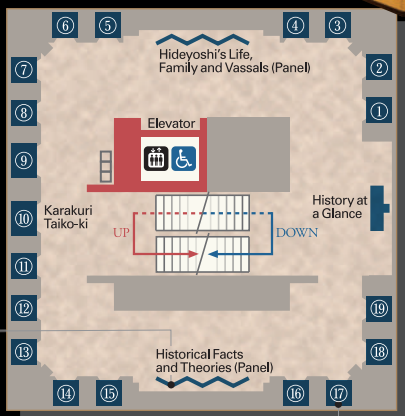

- **Karakuri Taiko-ki** (19 scenes in total, 1-2 minutes per scene)

The life of Hideyoshi Toyotomi
"Taiko" is introduced in miniature diorama.



8 F

Observation Deck

Enjoy a magnificent panoramic view of Osaka City from 50 m above the ground



*This gate is wheelchair-accessible.

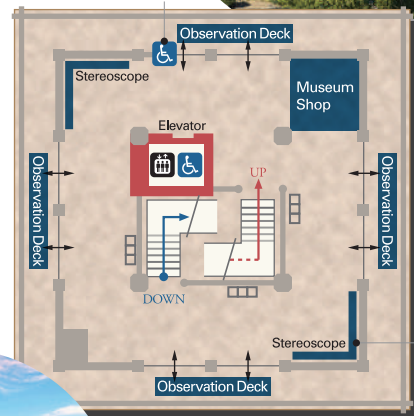

- **Stereoscope:**
"Famous Views of Naniwa"
Three-dimensional landscapes of "Old Osaka"

